

Modular Wall Track

 **SlackerSean**

[VIEW IN BROWSER](#)

updated 7. 2. 2022 | published 7. 2. 2022

Summary

Simple modular wall track to allow hanging items.

[Household](#) > [Other House Equipment](#)

Print as many 6" sections as you need for the length you require. Print one end cap for each side. Clips should be minimum of two. Add additional clips to maintain support as you deem fit. Number of hooks printed based on your needs.

Track and Ends:

Printing the track ends only needs supports on the bed. Print the sections with the single groove side on the bottom. Track sections twist lock together end to end. There are end caps to keep hooks from sliding off.

Wall Clips:

Print clips on their side. You can use supports everywhere to keep screw holes shaped correctly. Wall clips require flat head screws so clips fit track without issues. Can print as many wall clips as needed to where you feel secure. Wall clips snap on to track sections

Basic Hook:

Hooks should be printed on their side. Print as many hooks as required for your needs.

Model files

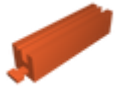

track.stl



left-track-end.stl



right-end-bracket.stl

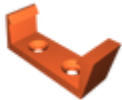

wall-clip.stl



basic-hook.stl

License

This work is licensed under a
[Creative Commons \(International License\)](#)



Public Domain

- ✓ | Sharing without ATTRIBUTION
- ✓ | Remix Culture allowed
- ✓ | Commercial Use
- ✓ | Free Cultural Works
- ✓ | Meets Open Definition

