

Prusa Mk2/2.5 Mesh Sideboxes



Tex

[VIEW IN BROWSER](#)

updated 9. 2. 2022 | published 8. 2. 2022

Summary

3d Mesh SideBoxes for Prusa Mk2/2.5S. Snap on to threaded rod. PETG



6.01 hrs



1 pcs



0.35 mm



0.40 mm



PET



122 g



Prusa
MK2.5/S

[3D Printers](#) > [3D Printers - Upgrades](#)

Tags: [prusa](#) [sidebox](#) [prusamk2](#) [sideboxes](#)

Loved the mesh sideboxes for the Prusa MK3 but could not find any for the Mk2.5. These Sideboxes clip onto the threaded rod of the Mk 2/2.5. Gcode is for PETG and has 2 stops for color change built in at the right points. Have also included the .3mf file so that you can change the print settings. Best part about these boxes is they keep the filament out of my enclosure!

This remix is based on



Prusa MK3S Mesh Side Boxes MMU2S

by dotson90



Prusa MK3 / MK3S / MK3S+ - SideBoxes for some Tools

by KalleKnall

Model files

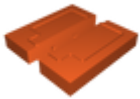

prusa-mk2-side-boxes-v9.3mf

Print files

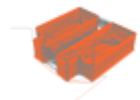

prusa-mk2-side-boxes-v9_035mm_petg.gcode

PET 0.40 mm 0.35 mm 6.01 hrs 122 g Prusa MK2.5/S

License

This work is licensed under a
[Creative Commons \(International License\)](#)



Public Domain

-
- ✓ | Sharing without ATTRIBUTION
 - ✓ | Remix Culture allowed
 - ✓ | Commercial Use
 - ✓ | Free Cultural Works
 - ✓ | Meets Open Definition

