

3D MODEL ONLY

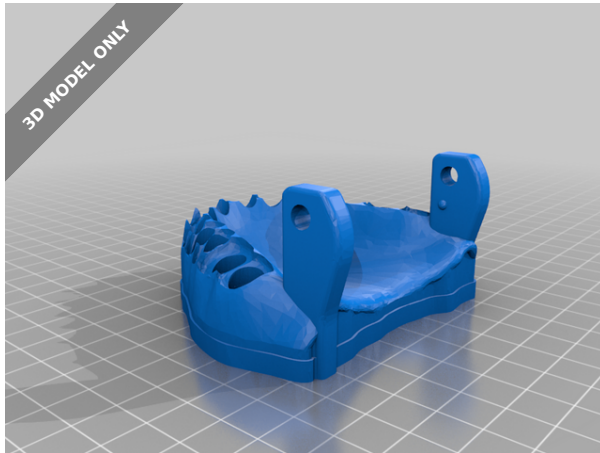

## Press and Glue Denture Bit Holder



HuberD

[VIEW IN BROWSER](#)

updated 12. 4. 2022 | published 8. 2. 2022

### Summary

Rather than have a pause in the print for placing the magnets, I bored out the bit holes so you can just put a drop of...

---

[Hobby & Makers](#) > [Tools](#)

---

Rather than have a pause in the print for placing the magnets, I bored out the bit holes so you can just put a drop of glue in and press your 8x3mm magnets.

Press and Glue Dentures 2 has a pair of 8x3mm holes in the bottom for attaching magnets to attach the print to your tool box.

### Print Settings

#### Printer Brand:

Creality

#### Printer:

Ender 5

#### Rafts:

No

**Supports:**

No

**Resolution:**

.2

**Infill:**

15

**Filament:** sunlu PLA

Category: Tools

## Model files



**png\_dentures.stl**

---



**png\_dentures\_2.stl**

---



**press\_and\_glue\_dentures\_1.stl**

---



**press\_and\_glue\_dentures\_2.stl**

[Find source .stl files on Thingiverse.com](#)

# License

This work is licensed under a  
**Creative Commons (4.0 International License)**



**Attribution—Noncommercial—Share Alike**

---

- ✗ | Sharing without ATTRIBUTION
- ✓ | Remix Culture allowed
- ✗ | Commercial Use
- ✗ | Free Cultural Works
- ✗ | Meets Open Definition