

Wera screwdriver holder



BigRedButton

[VIEW IN BROWSER](#)

updated 4. 9. 2022 | published 4. 9. 2022

Summary

Wall mount holder for Wera screwdrivers.

[Hobby & Makers](#) > [Tools](#)

Tags: [screwdriverholder](#) [wera](#)

Wall mount screwdriver holder for Wera screwdrivers. The design has a rail mounted to the wall and individual screwdriver holders that slot into place. The holders can be arranged as desired.

The holders have embossed the type and size of the screwdriver for easy identification. Recommend painting the embossed text.

Collection only includes the screwdrivers I own. As I no longer have access to the software used to design them, I cannot add more variants at this time.

Model files

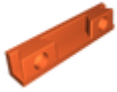

werawallmounttopx2.stl



werawallmounttopx4.stl

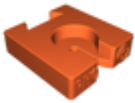

baseph0.stl



baseph1.stl

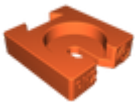

baseph2.stl



baseph3.stl



basepz0.stl

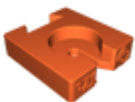

basepz1.stl



basepz2.stl



basepz3.stl

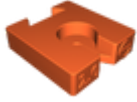

basesl2p0.stl

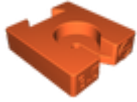

basesl3p5.stl

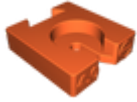

basesl4p0.stl



basesl6p5.stl

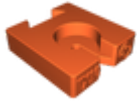

basetx10.stl



basetx15.stl

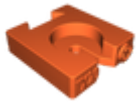

basetx20.stl



basetx25.stl



basetx30.stl



basehex2.stl

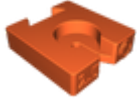

basehex2p5.stl

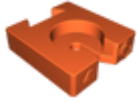

basehex4.stl

License ©



This work is licensed under a
[Creative Commons \(4.0 International License\)](https://creativecommons.org/licenses/by/4.0/)

Attribution

- ✗ | Sharing without ATTRIBUTION
- ✓ | Remix Culture allowed
- ✓ | Commercial Use
- ✓ | Free Cultural Works
- ✓ | Meets Open Definition