



CNC spindle dust shoe

 **vastempty**

[VIEW IN BROWSER](#)

updated 12. 4. 2022 | published 2. 12. 2019

Summary

A remix of MarcusWolschon's spindle dust shoe; but for a spindle I have on my ShapeOko.

[Hobby & Makers](#) > [Tools](#)

Tags: [cnc](#) [spindle](#) [dust](#) [shapeoko](#)

A remix of MarcusWolschon's spindle dust shoe; but for a spindle I have on my ShapeOko. The parts should be able to be scaled up/down to fit others.

Print instructions Category: Machine Tools Instructions

The parts from thing:31156 have been merged using MeshLab and scaled down 67% to fit a spindle similar to:

http://www.ebay.com/itm/300W-12V-24V-36V-48VDC-Engraving-Machine-Carving-MILLING-GRINDING-SPINDLE-MOTOR-/151033851776?pt=LH_DefaultDomain_0&hash=item232a51af80

The spindle's diameter is 52mm and mounted with thing:26740 (V2).

The top of the dust show was printed in ABS at 80% fill/ .3mm layer the bottom 40%/.3mm. No support necessary. The two halves are glued together with super glue. Careful not to glue to close to the clamp end.

My shop vac needed an hose adapter, which I custom made using thing: 97238. The dust shoe side, OS diameter of the adapter is 23mm (a little too loose, I may hot glue it in for a good seal). On the Shop vac side, the OS diameter is 35mm (inside 31). I ended up printing that in nylon for strength.

This thing is a work-in-progress. I have not spent alot of time with it, let me know your results. Thanks.

Model files



spindlevactopmerge_fixedv16.stl

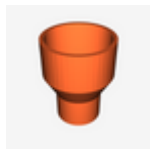

vacadapter.stl



spindlevactallbottommerge_fixedv17.stl

[Find source .stl files on Thingiverse.com](#)

License ©

This work is licensed under a
Creative Commons (4.0 International License)



Attribution

-
- ✗ | Sharing without ATTRIBUTION
 - ✓ | Remix Culture allowed
 - ✓ | Commercial Use
 - ✓ | Free Cultural Works
 - ✓ | Meets Open Definition

