



Light Boy adapter for Analogue Pocket

N Nate

[VIEW IN BROWSER](#)

updated 9. 2. 2022 | published 9. 2. 2022

Summary

An insert to fit a Hori Lightboy and Analogue Pocket



1.41 hrs



1 pcs



0.20 mm



0.40 mm



PLA



15 g



Prusa
MK3/S/S+

[Gadgets](#) > [Video Games](#)

Tags: [gameboy](#) [pocket](#)

After receiving my Analogue Pocket, I was disheartened to discover that it wasn't compatible with one of the finer gaming accessories of all time- The Hori Light Boy VLB-01.

I thought this would be an excellent opportunity to create a product to fill this void.

Printed in my default settings on a MK3S+ - 0.20 mm quality

Should print as is, no supports or modifications required on the plate.

Insert the adapter onto the Lightboy to have the device mate onto the surface, then slide the Pocket in at a straight 90 degree angle. I have the screen protector on, and it's a snug fit but doesn't appear to be overly tight.

Model files

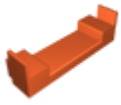

light_boy_pocket.stl

Print files



light_boy_pocket_02mm_pla_mk3s_1h25m.gcode

🌀 PLA 🌀 0.40 mm 📏 0.20 mm ⌚ 1.41 hrs ⚖️ 15 g 🖨️ Prusa MK3/S/S+

License ©

This work is licensed under a
[Creative Commons \(4.0 International License\)](#)



Attribution

-
- ✗ | Sharing without ATTRIBUTION
 - ✓ | Remix Culture allowed
 - ✓ | Commercial Use
 - ✓ | Free Cultural Works
 - ✓ | Meets Open Definition