



Makedo Discover Tool Organizer



Guido666

[VIEW IN BROWSER](#)

updated 12. 4. 2022 | published 10. 2. 2022

Summary

This is a series of slide-together trays, to store and organize the Makedo Discover set of cardboard box construction...



63.11 hrs



6 pcs



0.20 mm
0.30 mm



0.40 mm



PET



1083 g



Prusa
MK3/S/S+

[Household](#) > [Office](#)

Tags: [makedo](#) [toolorganizer](#)

This is a series of slide-together trays, to store and organize the Makedo Discover set of cardboard box construction tools.

<https://www.make.do/collections/all-products/products/a0126-discover>

The "SCRU"/"SCRU XL" drawers are intentionally designed to have one hole for each screw in the kit, so that you will know if one is missing (before you step on it!). If you prefer, there is a drawer model included, that will hold all the SCRUs instead.

NOTE: There is an image with the dimensions of the rails and grooves.

Print Settings

Printer Brand:

Prusa

Printer:

I3 MK3S

Rafts:

No

Supports:

No

Resolution:

0.3mm

Infill:

20%

Filament: eSun PETG

Notes:

Print these at standard settings (20% infill, 2 shells) in PETG, but set the filament setting to bump up the bed temp to 105C after the first layer, to make sure it stays stuck to the bed flat.

If it does peel up (e.g. in the corners), you may have a little trouble sliding them together. If so, look for the "smooth" spots where they rubbed, and trim the rails with a knife.

Turn on ironing for "topmost surfaces only", to make the top of the rails nice and smooth.

Category: Organization

Model files

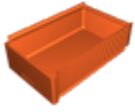

ptw-107-1-pt-0698_scru_drawer_r-_16jan2022.3mf



ptw-107-1-pt-0696_scru_tray_30x.sldprt



ptw-107-1-pt-0697_scru_xl_tray_30x.sldprt



ptw-107-1-pt-0700_bottom_plate_r-_31jan2022.stl

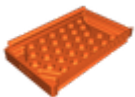

ptw-107-1-pt-0696_scru_tray_30x_r-_12jan2022.3mf



ptw-107-1-pt-0700_bottom_plate.sldprt

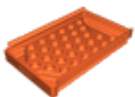

ptw-107-1-pt-0696_scru_tray_30x_r-_12jan2022.stl

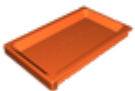

ptw-107-1-pt-0701_top_cover_r-_1feb2022.3mf

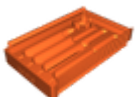

ptw-107-1-pt-0695_tool_tray_discover_r2_8jan2022.3mf

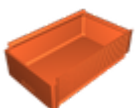

ptw-107-1-pt-0698_scru_drawer_r-_16jan2022.stl



ptw-107-1-pt-0695_tool_tray_discover.sldprt

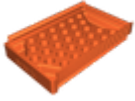

ptw-107-1-pt-0697_scru_xl_tray_30x_r_13jan2022.stl



ptw-107-1-pt-0700_bottom_plate_r_31jan2022.3mf

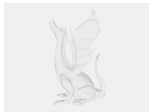

ptw-107-1-pt-0701_top_cover.sldprt

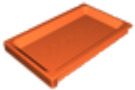

ptw-107-1-pt-0701_top_cover_r_1feb2022.stl



ptw-107-1-pt-0698_scru_drawer.sldprt

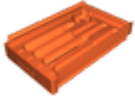

ptw-107-1-pt-0695_tool_tray_discover_r2_8jan2022.stl

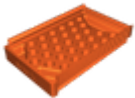

ptw-107-1-pt-0697_scru_xl_tray_30x_r_13jan2022.3mf

Print files



ptw-107-1-pt-0701_top_cover_r_1feb2022_02mm_pe.gcode

⊗ PET ⊗ 0.40 mm ≡ 0.20 mm ⌚ 10.14 hrs ⚖ 115 g 🖨 Prusa MK3/S/S+



ptw-107-1-pt-0698_scru_drawer_r_16jan2022_03mm.gcode

PET 0.40 mm 0.30 mm 11.20 hrs 218 g Prusa MK3/S/S+

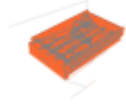

ptw-107-1-pt-0695_tool_tray_discover_r2_8jan202.gcode

PET 0.40 mm 0.30 mm 11.70 hrs 225 g Prusa MK3/S/S+



ptw-107-1-pt-0700_bottom_plate_r_31jan2022_02m.gcode

PET 0.40 mm 0.20 mm 7.21 hrs 95 g Prusa MK3/S/S+

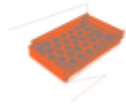

ptw-107-1-pt-0697_scru_xl_tray_30x_r_13jan2022.gcode

PET 0.40 mm 0.30 mm 12.39 hrs 237 g Prusa MK3/S/S+

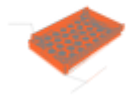

ptw-107-1-pt-0696_scru_tray_30x_r_12jan2022_03.gcode

PET 0.40 mm 0.30 mm 10.47 hrs 193 g Prusa MK3/S/S+

[Find source .stl files on Thingiverse.com](#)

License

This work is licensed under a
Creative Commons (4.0 International License)



Attribution

- ✗ | Sharing without ATTRIBUTION
- ✓ | Remix Culture allowed
- ✓ | Commercial Use
- ✓ | Free Cultural Works
- ✓ | Meets Open Definition

