



## Commodore 64 - Cartridge Case (Easy to print on FDM)

 **Bookaroo**

[VIEW IN BROWSER](#)

updated 12. 4. 2022 | published 11. 2. 2022

### Summary

Hi all, I have made my own version of the Commodore 64 Cartridge case, that is easy to print on an FDM regular 3D...

[Toys & Games](#) > [Outdoor Toys](#)

Tags: [case](#) [cartridge](#) [easytoprint](#) [easy](#) [commodore](#)  
[easyprint](#) [commodore64](#)

Hi all, I have made my own version of the Commodore 64 Cartridge case, that is easy to print on an FDM regular 3D Printer.

You can print this one face down no support needed.

I have a regular version and one with a hole for a small switch.

I have use it with a Dual diagnostic card from ebay, the switch can switch between the two ROMS.

I also have included my Fusion 360 file if you want to do some remix.

Use a M3 Flat Head Screw between 12 and 14mm long.

Enjoy!

## Print Settings

### Printer Brand:

Prusa

### Printer:

I3 MK3S

### Rafts:

No

### Supports:

No

### Resolution:

0.1 mm or 0.2 mm

### Infill:

15%

**Filament:** Amz3D PLA Black

### Notes:

I have included a small 0.1mm layer for the bottom screw to be sure that your printer does a bridge, you just have to punch it out with a small screw driver.

Category: Toy & Game Accessories

## Model files

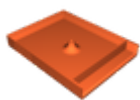

commodore\_cartridge\_case\_top\_no\_hole.stl

---

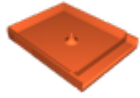

**commodore\_cartridge\_case\_bottom\_no\_hole.stl**



**commodore\_64\_cartridge\_case\_fdm\_printer\_friendly.f3d**



**commodore\_cartridge\_case\_top\_with\_hole.stl**

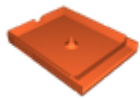

**commodore\_cartridge\_case\_bottom\_with\_hole.stl**

[Find source .stl files on Thingiverse.com](https://www.thingiverse.com)

## License ©



This work is licensed under a  
**Creative Commons (4.0 International License)**

### Attribution

- ✗ | Sharing without ATTRIBUTION
- ✓ | Remix Culture allowed
- ✓ | Commercial Use
- ✓ | Free Cultural Works
- ✓ | Meets Open Definition