

Ball Scoop



LoboCNC

[VIEW IN BROWSER](#)

updated 12. 4. 2022 | published 11. 2. 2022

Summary

This handy ball scoop makes quick work of picking up pickleballs or tennis balls. Unlike the rolling-type collectors,...

[Sports & Outdoor](#) > [Other Sports](#)

This handy ball scoop makes quick work of picking up pickleballs or tennis balls. Unlike the rolling-type collectors, you can easily tease balls out of corners or from up against the irregular bottom of chain-link fencing. It has a socket for a standard broom handle (3/4"-5 thread) and uses a drawstring sack for holding the balls. An internal flap keeps the balls from rolling back out. Just hold the flap open and dump the balls back out the front to empty.

This is a great accessory for my Pickleball Machine: <https://www.thingiverse.com/thing:3766338>

Print Settings

Printer:

UDIO

Rafts:

No

Supports:

Yes

Resolution:

0.2mm

Infill:

20%

Filament:

Inland PLA

Dandelion Yellow

Notes:

The only piece that needs supports is the flap.

Post-Printing =====

To complete the unit, you will need two 4-40 x 1/2" long screws (or M3 x 12mm), one 1/4-20 x 1.75" long screw, a standard broom handle, and a drawstring collection bag. I just sewed my own (14" wide x 22" long) and it holds 40+ balls. You could also buy something like this: https://www.amazon.com/Augbunny-Durable-Drawstring-Resistant-4-Pack/dp/B07KY75DSG/ref=sr_1_3?keywords=stuff%2Bsack&qid=1565977888&s=sporting-goods&sr=1-3&th=1&psc=1

The sack needs to be at least 12" wide to slip over the lip on the back end of the body.

To assemble the flap, insert the little levers from the inside of the scoop and insert the two 4-40 screws through the tabs on the body and into holes in the flap lever as shown in the photos. If the flap doesn't flip back & forth completely smoothly, remove it and sand or scrape off any lumps or bumps left from printing.

Slip the drawstring bag over the back of the body and tie the ends very tightly. (The little sliding gizmos found on most drawstring bags won't hold it sufficiently tightly - you'll need to tie a knot.) Use the 1/4-20 screw to attach the socket to the body and then screw in your broom handle.

To use, a deft flick of the scoop will allow you to pick up maybe 4 or 5 balls with a single swipe. Swipe towards any fencing in case balls go scooting

away. Lift the front end slightly after swiping to make sure the balls get trapped behind the flap.

Category: Sport & Outdoors

Model files

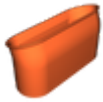

scoopbody_132249.stl



scoopflap_132249.stl



scoopsocket_132249.stl

[Find source .stl files on Thingiverse.com](#)

License ©

This work is licensed under a
[Creative Commons \(4.0 International License\)](#)



Attribution—Noncommercial—Share Alike

- ✗ | Sharing without ATTRIBUTION
- ✓ | Remix Culture allowed
- ✗ | Commercial Use
- ✗ | Free Cultural Works
- ✗ | Meets Open Definition