

The joyful spoolholder



IBICO74

[VIEW IN BROWSER](#)

updated 3. 12. 2019 | published 3. 12. 2019

Summary

A spoolholder that would probably fit most of your needs.



16.40 hrs



2 pcs



0.27 mm



0.40 mm



PLA



181 g



Prusa
MK3/S/S+

[3D Printers](#) > [Accessories](#)

Tags: [spoolholder](#) [filamentspoolholder](#) [spoolroller](#)
[filamentholder](#)

A spoolholder that would probably fit most of your needs.

I'll upload instructional videos here: <https://youtu.be/JyBSdGyvAY>

Print instructions

6 perimeter, 6 top and 6 bottom. 15% infill.

I have uploaded both 3mf of the bed and gcodes. The gcodes are from my prusa MK3s setup and should work good since I have adjusted down speed and acceleration.

No special gcodes at the beginning and end other then 100% flow all the time.

Model files



complete_project_joyful_spoolholder.3mf



christmastree_joyful_spoolholder.3mf



lasefot.step

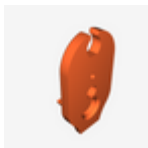

veggfeste_lav-v2.stl

Print files



christmastree_joyful_spoolholder_0268mm_pla_mk3.gcode

⚙️ PLA ⚙️ 0.40 mm ⚙️ 0.27 mm ⌚ 3.63 hrs ⚖️ 53 g 🖨️ Prusa MK3/S/S+

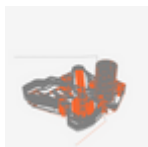

complete_project_joyful_spoolholder_0268mm_pla_.gcode

⚙️ PLA ⚙️ 0.40 mm ⚙️ 0.27 mm ⌚ 12.77 hrs ⚖️ 128 g 🖨️ Prusa MK3/S/S+

License

This work is licensed under a
Creative Commons (4.0 International License)



Attribution—Noncommercial—No Derivatives

- ✕ | Sharing without ATTRIBUTION
- ✕ | Remix Culture allowed
- ✕ | Commercial Use
- ✕ | Free Cultural Works
- ✕ | Meets Open Definition