

2020 Spool Holder Horizontal Position



Geekdad_3D

[VIEW IN BROWSER](#)

updated 12. 4. 2022 | published 12. 2. 2022

Summary

Just remixed it to shorten the overall length and place the screw holes on top and bottom. Also evened out the bottom...

[3D Printers](#) > [Accessories](#)

Tags: [filamentspoolholder](#) [kossel](#) [2020extrusion](#)

Just remixed it to shorten the overall length and place the screw holes on top and bottom. Also evened out the bottom to lay flat on the printer bed.

EDIT*** I just uploaded a new version after printing and the 2020 mount broke at the top. I beefed up the back of the mount area to hopefully keep it stronger.

Print Settings

Rafts:

Doesn't Matter

Supports:

Yes

Category: 3D Printer Accessories

Model files

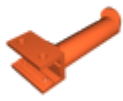

2020_spool_holder_horizontal_beefy.stl

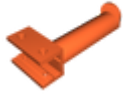

2020_spool_holder_horizontal.stl

Other files



sources.txt

[Find source .stl files on Thingiverse.com](https://www.thingiverse.com/thing/4500000)

License ©

This work is licensed under a
[Creative Commons \(4.0 International License\)](https://creativecommons.org/licenses/by/4.0/)



Attribution

-
- ✗ | Sharing without ATTRIBUTION
 - ✓ | Remix Culture allowed
 - ✓ | Commercial Use
 - ✓ | Free Cultural Works
 - ✓ | Meets Open Definition