



Toilet Paper Roll Holder



TomChaton

[VIEW IN BROWSER](#)

updated 15. 2. 2022 | published 12. 2. 2022

Summary

3d Printed, oak and brass toilet roll holder

[Household](#) > [Bathroom](#)

Tags: [holder](#) [paper](#) [toilet](#) [roll](#)

Print the parts with at least 70% infill for greater strength. Example was printed using black petg at higher temperatures for better layer adhesion.

Video of it working [here](#)

Assembly requires:

- 2 x 50mm M3 bolts
- 2 x 8mm M3 threaded inserts
- 4 x 4mm x 30-50mm wood screws
- suitable mounting plate (image uses 11mm thick white oak).

Insert the M3 threaded inserts into the cam part and insert the 50mm M3 into the bottom of the stalk. Screw together. The parts should be loose enough to move freely.

Use the template to drill 4 holes in the mounting plate, and screw the stalks to the backing material from the back.

Depending on the length of the wood screws you're using and the thickness of the mounting plate, you may want to deepen the holes on the bottom of the stalk. As printed, these are 20mm deep.

Model files

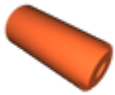

toiletrollholder-leftstalk.stl

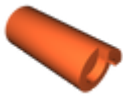

toiletrollholder-right-stalk.stl

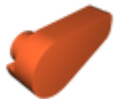

toiletrollholder-leftcam.stl

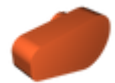

toiletrollholder-right-cam.stl

Other files



template.pdf

☐ Template for the holes in the backing material

License

This work is licensed under a
[Creative Commons \(4.0 International License\)](https://creativecommons.org/licenses/by-nc/4.0/)



Attribution-NonCommercial

- ✗ | Sharing without ATTRIBUTION
- ✓ | Remix Culture allowed
- ✗ | Commercial Use
- ✗ | Free Cultural Works
- ✗ | Meets Open Definition