



Bed Pacifier Holder

 **David Elentok**

[VIEW IN BROWSER](#)

updated 12. 2. 2022 | published 12. 2. 2022

Summary

Attaches to a bedhead and holds two pacifiers



2.56 hrs



1 pcs



0.20 mm



0.40 mm



PLA



33 g



Prusa MINI /
MINI+

[Household](#) > [Bedroom](#)

Tags: [holder](#) [hanger](#) [bed](#) [baby](#) [pacifier](#)

I wanted to put extra pacifiers in my son's bed in an easy-to-find location in case he wakes looking for a pacifier.

I printed it on the side with supports between the two hangers, with 15% infill but 100% infill on the connections (open the 3mf file in PrusaSlicer to see).

The fusion 360 source files are provided and are fully parametric, for example you can specify the bedhead depth and the width of the pacifiers.

Model files



pacifier-hanger.3mf

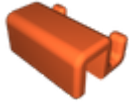

pacifier-hanger.stl



pacifier-hanger.f3d

☐ Fusion 360 source file

Print files



pacifier-hanger_02mm_pla_mini_2h34m.gcode

PLA 0.40 mm 0.20 mm 2.56 hrs 33 g Prusa MINI / MINI+

License

This work is licensed under a
[Creative Commons \(4.0 International License\)](#)



Attribution-ShareAlike

- ✗ | Sharing without ATTRIBUTION
- ✓ | Remix Culture allowed
- ✓ | Commercial Use
- ✓ | Free Cultural Works
- ✓ | Meets Open Definition