

Remix of the fan mount for a 4020 fan

T Tailslide

[VIEW IN BROWSER](#)

updated 12. 4. 2022 | published 13. 2. 2022

Summary

Remix of the fan mount for a 4020 fan with tronxy sensor. It positions the duct a little farther than the original...

[3D Printers](#) > [3D Printers - Upgrades](#)

Remix of the fan mount for a 4020 fan with tronxy sensor. It positions the duct a little farther than the original from the nozzle so my heat sink fan had room. Picture shown with my replacement carriage from <https://www.thingiverse.com/thing:2493062>, but it should work with original carriage too.

Edit: added second version of duct that ends closer to nozzle.

Print Settings

Printer:

FLSUN I3

Rafts:

No

Supports:

Yes

Resolution:

0.2mm

Infill:

60%

Category: 3D Printer Parts

Model files



tronxy_sensor_-_4020_fan_offset4.stl

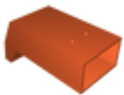

tronxy_sensor_-_4020_fan_offset_-closer_to_nozzle.stl

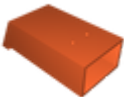

tronxy_sensor_-_4020_fan_offset4_-duct.stl

Other files



sources.txt

[Find source .stl files on Thingiverse.com](#)

License ©

This work is licensed under a
Creative Commons (4.0 International License)



Attribution

- ✗ | Sharing without ATTRIBUTION
- ✓ | Remix Culture allowed
- ✓ | Commercial Use
- ✓ | Free Cultural Works
- ✓ | Meets Open Definition