



Toothbrush / Toothpaste Holder



CWCDesigns

[VIEW IN BROWSER](#)

updated 12. 4. 2022 | published 5. 12. 2019

Summary

Upgraded to version 2 of my toothpaste holder <https://www.thingiverse.com/thing:4005721> This version adds insets for...

[Household](#) > [Bathroom](#)

Tags: [holder](#) [stand](#) [bathroom](#) [toothbrush](#) [tube](#)
[toothpaste](#) [toothbrushholder](#) [toothpasteholder](#) [bathroomsink](#)

Upgraded to version 2 of my toothpaste holder <https://www.thingiverse.com/thing:4005721> This version adds insets for each tube spot to hold flat standing caps as well as standard twist caps. Three toothbrush spots are added where version one had none. On the bottom there are now room for six feet. First version only has three. There will be one more version coming that I feel is a bit more stylish and has room for 3 tubes and 4 brushes.

Print instructions Category: Bathroom Print Settings

Printer Brand: Prusa

Printer: i3 MK3

Rafts: No

Supports: No

Resolution: .20

Infill: 15

Model files

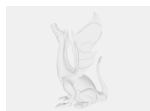

large_display_holder_2_13361.stl

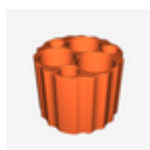

holder_2.stl

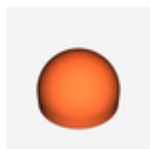

foot.stl

[Find source .stl files on Thingiverse.com](#)

License ©

This work is licensed under a
Creative Commons (4.0 International License)



Attribution—Noncommercial—No Derivatives

- ✗ | Sharing without ATTRIBUTION
- ✗ | Remix Culture allowed
- ✗ | Commercial Use
- ✗ | Free Cultural Works
- ✗ | Meets Open Definition