



Spool-Holder



Star Blink

[VIEW IN BROWSER](#)

updated 5. 5. 2022 | published 27. 4. 2022

Summary

Easy to print. Easy to assemble Spool Holder

[3D Printers](#) > [Accessories](#)

ENG:

Easy to print, easy to assemble Spool holder.

This is just the thing, on which the spool sits.

You need:

2 x Filamentholder-Screw

1 x Filamentholder-Corpus

After print, you just screw the three parts together.

Screws diameter: 19 mm

Corpus diameter: 50 mm

Corpus lenght: 98 mm

GER:

Einfach zu drucken, einfach zu montierender Spulenhalter.

Dies ist nur das Teil, auf dem die Spule sitzt.

Sie benötigen:

2 x Filamentholder-Screw

1 x Filamentholder-Corpus

Nach dem Druck schrauben Sie die drei Teile einfach zusammen.

Durchmesser der Schrauben: 19 mm

Korpus-Durchmesser: 50 mm

Korpus-Länge: 98 mm

This remix is based on



Filament spool holder without bearings

by Akeno

Model files

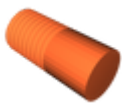

filamentholder-screw.stl

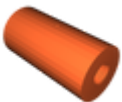

filamentholder-corpus.stl

License ©

This work is licensed under a
Creative Commons (4.0 International License)



Attribution-NonCommercial

- ✗ | Sharing without ATTRIBUTION
- ✓ | Remix Culture allowed
- ✗ | Commercial Use
- ✗ | Free Cultural Works
- ✗ | Meets Open Definition