

## Brio connector replacement



Antimaterie

[VIEW IN BROWSER](#)

updated 18. 2. 2022 | published 14. 2. 2022

### Summary

if a connector of a BRIO rail is broken, this can be replaced with this item.

---

[Toys & Games](#) > [Building Toys](#)

---

This replaces a broken connector for BRIO track.

#### Print instructions:

- Print as you like, no special instructions.
- perhaps use ironing to have a very smooth top
- use PLA, so you can use wood glue to glue it

#### Installation:

- remove all leftovers from prior connector.
- Make a hole with a 6mm drill.
- check if you can slide in the replacement part, if not make the hole a tiny bit larger

#### additional notes

I'm interested in your feedback to improve my stuff! So give me likes, post makes, comment and rate the print to show others and me how well it goes.

If you post a make, let me know which filament you use.

If you want to support me by donating a coffee go to <https://ko-fi.com/antimaterie> I would really happy about it. The money will be invested in all stuff regarding 3d printing to give more and better quality models.

In general my Prints are not for commercial use, but if you a print farm owner and want to sell some of my stuff, please contact me.

Hope you enjoy my models.

## Model files

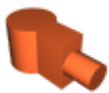

brio\_nupsi\_ersatz.stl

## License ©

This work is licensed under a  
**Creative Commons (4.0 International License)**



**Attribution-NonCommercial**

- 
- ✗ | Sharing without ATTRIBUTION
  - ✓ | Remix Culture allowed
  - ✗ | Commercial Use
  - ✗ | Free Cultural Works
  - ✗ | Meets Open Definition