



## Switch Mount Buggy - Buggster 16BL30



Anthlon

[VIEW IN BROWSER](#)

updated 1. 5. 2022 | published 14. 2. 2022

## Summary

Modified switch mout for 3dsets model 7 family , when using 16BL30 ESC

[Toys & Games](#) > [Vehicles](#)

Tags: [switch](#) [3dsets](#) [customized](#) [brushless](#) [buggy](#)  
[buggster](#)

Modified switch bracked for 3Dsets buggy for those who use hobbywing 16BL30. Use this two parts instead the original Switch Bracket A / B on page 63 of Build Guide

Also you will need to use screw M3x16, not listed M3x14

This design reflects original idea of two part mouting, but there are also available mounts from single part-print objects which accomodate the switch sufficently.

# Model files

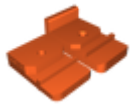

16bl30-switch-mount.3mf



16bl30-switch-mount.stl

## License

This work is licensed under a  
[Creative Commons \(International License\)](#)



**Public Domain**

- 
- ✓ | Sharing without ATTRIBUTION
  - ✓ | Remix Culture allowed
  - ✓ | Commercial Use
  - ✓ | Free Cultural Works
  - ✓ | Meets Open Definition