



Laser Proximity Detector



Plexi

[VIEW IN BROWSER](#)

updated 12. 4. 2022 | published 14. 2. 2022

Summary

Customized version of <https://www.thingiverse.com/thing:468917> Created with Customizer!...

[Hobby & Makers](#) > [Tools](#)

Tags: [laser](#) [sensor](#) [detector](#) [encoder](#) [customized](#)
[proximity](#)

Customized version of <https://www.thingiverse.com/thing:468917>

Created with Customizer! https://www.thingiverse.com/apps/customizer/run?thing_id=468917

I created this custom enclosure for this Laser Proximity Detector.

<https://www.amazon.com/gp/product/B00NJNYQ9G>

I added holes in the lid for the laser emitter and the lensed detector. I'm using this setup to detect holes in a wheel to measure speed in feet per minute of a cart. The display is this unit: <https://www.thingiverse.com/thing:3352007>

The backstop is needed because the laser will bounce off objects on the other side of the wheel. I glued static foam to the backstop which absorbs

the laser beam and keeps it from bouncing back. Only the spokes of the wheel reflect the beam back to the detector.

Instructions

Using the following options:

width = 25

length = 56

height = 20

wall_thickness = 2.2

edge_roundness = 4

tolerance = 0.3

\$fn = 20

Category: Tool Holders & Boxes

Model files

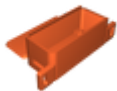

laserproximitydetectorenclosurev4.stl



laserproximitybackstopv1.stl

Other files

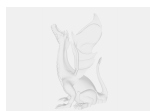

sources.txt

[Find source .stl files on Thingiverse.com](#)

License

This work is licensed under a
Creative Commons (4.0 International License)



Attribution-ShareAlike

- ✗ | Sharing without ATTRIBUTION
- ✓ | Remix Culture allowed
- ✓ | Commercial Use
- ✓ | Free Cultural Works
- ✓ | Meets Open Definition