

Prusa i3 Y Axis Bearing Rod Support



Plexi

[VIEW IN BROWSER](#)

updated 12. 4. 2022 | published 14. 2. 2022

Summary

This is a replacement Y Axis Bearing Rod support for Prusa i3 Aluminum extrusion printers. It improves over stock...

[3D Printers](#) > [3D Printers - Upgrades](#)

This is a replacement Y Axis Bearing Rod support for Prusa i3 Aluminum extrusion printers. It improves over stock versions by having a ridge that tightly aligns with the aluminum extrusion and having a bearing rod clamping feature. There are right and left versions because the supports need to be mirrored to clear the bed adjusting screws. It requires two 5mm x 10mm cap screws for mounting and one 3mm x 12mm cap screw and nut for the clamp. You'll also need the captive nut used with the extrusion which came with the printer kit.

Print Settings

Printer Brand:

RepRap

Printer:

Prusa i3

Rafts:

No

Supports:

No

Resolution:

0.1mm

Infill:

40%

Notes:

PLA

extruder 195c

bed 55c

Category: 3D Printer Parts

Model files



3d_printer_y_axis_right_supportv3.stl

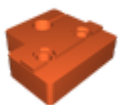

3d_printer_y_axis_left_supportv3.stl

[Find source .stl files on Thingiverse.com](#)

License ©

This work is licensed under a
Creative Commons (4.0 International License)



Attribution

- ✘ | Sharing without ATTRIBUTION
- ✓ | Remix Culture allowed
- ✓ | Commercial Use
- ✓ | Free Cultural Works
- ✓ | Meets Open Definition