



Holder Dial Indicator HBM Lathe



werz 99

[VIEW IN BROWSER](#)

updated 15. 2. 2022 | published 15. 2. 2022

Summary

Lathebed Dial Indicator



1.17 hrs



2 pcs



0.30 mm



0.40 mm



PET



21 g



Prusa
MK3/S/S+

[Hobby & Makers](#) > [Tools](#)

Tags: [dialindicator](#) [lathe](#) [lathebed](#)

This Dial Indicator Holder fits to the Lathe Bed of my HBM 250 x 550 Profi Norton. Made for a Dial Indicator with 8mm axis.

Additional Hardware:

M6 x 50 Screw with Knob

M6 Nut

Small M3 Cap Screw

Model files

hbm-dialhalter-laengs_bottom.stl

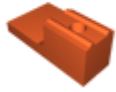

hbm-dialhalter-laengs_top.stl



Print files

hbm-dialhalter-laengs_top_03mm_petg_mk3s_48m.gcode



PET 0.40 mm 0.30 mm 0.80 hrs 15 g Prusa MK3/S/S+

hbm-dialhalter-laengs_bottom_03mm_petg_mk3s_22m.gcode



PET 0.40 mm 0.30 mm 0.37 hrs 6 g Prusa MK3/S/S+

License ©

This work is licensed under a
[Creative Commons \(4.0 International License\)](#)



Attribution—Noncommercial—Share Alike

- ✗ | Sharing without ATTRIBUTION
- ✓ | Remix Culture allowed
- ✗ | Commercial Use
- ✗ | Free Cultural Works
- ✗ | Meets Open Definition

