



## 22mm Rally Watch Band

 **PureDeath**

[VIEW IN BROWSER](#)

updated 12. 4. 2022 | published 16. 2. 2022

### Summary

A 22mm rally style watch band. This thing was edited with Tinkercad. Edit it...

[Hobby & Makers](#) > [Other Ideas](#)

Tags: [watchband](#) [ninjaflex](#) [flexiblefilament](#) [22mm](#) [rally](#)

A 22mm rally style watch band.

This thing was edited with Tinkercad. Edit it online <https://www.tinkercad.com/things/5K7I5LujZfh>

### Print Settings

#### Printer:

Flashforge Creator Pro

#### Rafts:

No

#### Supports:

No

**Resolution:**

.25

**Infill:**

100%

**Notes:**

Use NinjaFlex (<https://ninjatek.com/products/filaments/ninjabflex/>)

Post-Printing =====

I used a soldering iron to melt any shell layers to the infill and to strengthen the nob on the connector (I found this to be the weak link)

Category: 3D Printing

## Model files

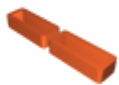

**watch\_band\_loops.stl**



**blank\_watch\_band\_part\_a.stl**



**blank\_watch\_band\_part\_b\_1.stl**



**rally\_watch\_band.stl**

## Other files



**sources.txt**

[Find source .stl files on Thingiverse.com](#)

## License

This work is licensed under a  
**Creative Commons (4.0 International License)**



**Attribution-ShareAlike**

- 
- ✗ | Sharing without ATTRIBUTION
  - ✓ | Remix Culture allowed
  - ✓ | Commercial Use
  - ✓ | Free Cultural Works
  - ✓ | Meets Open Definition