



## Quicko T12 battery pack (Makita 18V, Parkside 20V)



SHR3D.eu

[VIEW IN BROWSER](#)

updated 15. 3. 2022 | published 16. 2. 2022

## Summary

Attachment for operating the Quicko T12 micro stick from Makita or Parkside battery hand tools.



7.67 hrs



6 pcs



0.20 mm



0.40 mm



PLA



86 g



Prusa MINI /  
MINI+

[Hobby & Makers](#) > [Electronics](#)

Tags: [car](#) [battery](#) [soldering](#) [tools](#) [solder](#) [parkside](#) [mobile](#) [camping](#) [automobile](#) [makita](#) [solderingstation](#) [hakko](#) [18v](#) [makita18v](#) [batterymakita](#) [t12](#) [hakkot12](#) [parkside20v](#) [20v](#) [quicko](#) [quickot12](#) [x20v](#)

Easily printable extender for Quicko T12 microsolder and its other clones of the same size, which allows this microsolder to be elegantly operated on batteries designed for Makita or Parkside hand cordless tools, which is useful not only in the workshop, but especially for small repairs in the car, or on the road, etc. The soldering station is inserted from the front into the corresponding hole by slightly pressing the latch on the underside of the

top part. To remove the station, simply press the latch lever lightly again. This secures the station in the holder and prevents it from falling out, for example during handling or pulling on the soldering pen cable. The attachment itself is designed as a two-part unit for easier printing without supports, with the lower part serving for connecting the battery (it is possible to choose a version for Makita or Parkside batteries) and the upper part forming the grip itself. Here it is possible to choose from a version without text or with text (custom can be edited in the included .scad file).

To assemble, you will need 4 M3x10 screws, 4 M3 threaded inserts, a power cord for the soldering iron and suitable material to make the contacts for connecting to the battery (in the case of the Makita battery version this is two ideally 10x45x0.5mm copper strips. For Parkside then two phased connectors - 4.8mm pins)

Material:

Soldering station - <https://www.banggood.com/cs/Quicko-T12-942-MINI-OLED-Digital-Soldering-Station-T12-907-Handle-with-T12-K-Iron-Tips-Welding-Tool-p-1326151.html>

Threaded insert variant 1 - <https://www.tme.eu/cz/details/dr11m3/zavitove-vlozky/dremec/11m3/>

Threaded insert variant 2 - <https://www.tme.eu/cz/details/kvt-001m3/zavitove-vlozky/kvt-fastening/300113358/>

Faston connectors - <https://www.tme.eu/cz/details/2673.05.00.9/konektory-neizolovane/imp/>

[CZ]

Článek o této pájce od mého kamaráda Peťana, na jehož popud tento úchyt vznikl, je dostupný na: <https://www.mylms.cz/pajeci-stanice-t12-s-adapterem-na-akumulator/>

## Model files



t12-blank.stl

---



**t12-shr3d.stl**

---



**t12-mylms.stl**

---



**t12-prusaprinters.stl**

---

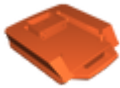

**parkside.stl**

---



**makita.stl**

---



**t-12.scad**

---

## Print files



**t12-mylms\_02mm\_pla\_mini\_5h1m.gcode**

⚙️ PLA   ⚙️ 0.40 mm   ⚙️ 0.20 mm   ⌚ 5.02 hrs   ⚖️ 53 g   🖨️ Prusa MINI / MINI+

---



**t12-prusaprinters\_02mm\_pla\_mini\_5h2m.gcode**

⚙️ PLA   ⚙️ 0.40 mm   ⚙️ 0.20 mm   ⌚ 5.03 hrs   ⚖️ 53 g   🖨️ Prusa MINI / MINI+

---



### t12-blank\_02mm\_pla\_mini\_4h52m.gcode

PLA 0.40 mm 0.20 mm 4.87 hrs 52 g Prusa MINI / MINI+



### t12-shr3d\_02mm\_pla\_mini\_5h1m.gcode

PLA 0.40 mm 0.20 mm 5.01 hrs 53 g Prusa MINI / MINI+



### parkside\_02mm\_pla\_mini\_2h48m.gcode

PLA 0.40 mm 0.20 mm 2.80 hrs 34 g Prusa MINI / MINI+



### makita\_02mm\_pla\_mini\_6h46m.gcode

PLA 0.40 mm 0.20 mm 6.77 hrs 80 g Prusa MINI / MINI+

## License

This work is licensed under a  
[Creative Commons \(4.0 International License\)](https://creativecommons.org/licenses/by/4.0/)



### Attribution

- ✗ | Sharing without ATTRIBUTION
- ✓ | Remix Culture allowed
- ✓ | Commercial Use
- ✓ | Free Cultural Works
- ✓ | Meets Open Definition