



Creality CR/Ender Spatula Holder



Padi_04

[VIEW IN BROWSER](#)

updated 20. 3. 2022 | published 20. 3. 2022

Summary

Creality compatible spatula holder



0.75 hrs



1 pcs



0.16 mm



0.40 mm



PLA



6 g



Other

[3D Printers](#) > [3D Printers - Upgrades](#)

Tags: [cr10](#) [creality](#) [ender](#) [scraper](#) [spatula](#) [crealitycr10](#)
[spatulaholder](#) [cr10smart](#)

Got tired of the spatula being the only tool without a designated spot around my CR-10 Smart. Designed in Fusion 360.

- This holder can be attached to any Creality printer (2020 extrusion) using a T3 nut and M3 bolt.
- Slot has a slight taper for easier insertion.
- Hole spacing allow for the part to be fitted in a single rail or diagonally, just not parallel to the rail.
- Compatible with any spatula with a blade sized 39x2mm or smaller.

Print as oriented in the STL. Infill and supports optional.

Print Settings

Printer Brand:

Creality

Printer:

CR-10 Smart

Rafts:

No

Layer Adhesion:

Brim (optional)

Infill:

10% (optional)

Filament:

Creality PLA CR Series

Model files



creality-spatula-holder.f3d

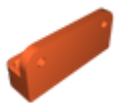

creality-spatula-holder.stl

Print files



cr-10-smart-_creality-spatula-holder.gcode

⚙ PLA ⚙ 0.40 mm ≡ 0.16 mm ⌚ 0.75 hrs ⚖ 6 g

License

This work is licensed under a
Creative Commons (4.0 International License)



Attribution-NonCommercial

- ✗ | Sharing without ATTRIBUTION
- ✓ | Remix Culture allowed
- ✗ | Commercial Use
- ✗ | Free Cultural Works
- ✗ | Meets Open Definition