

Reading Head Case for DRO



werz 99

[VIEW IN BROWSER](#)

updated 30. 3. 2022 | published 20. 3. 2022

Summary

Case for the Reading Head and Interface of the Magnetic DRO



2.04 hrs



2 pcs



0.20 mm



0.40 mm



PLA
PET



16 g



Prusa
MK3/S/S+

[Hobby & Makers](#) > [Mechanical Parts](#)

Tags: [light](#) [case](#) [dro](#) [readinghead](#)

Readinghead for Magnetic DRO fits on the C-Profile 17 x 11 x 2 mm that holds the Magnetic Tape for the Digital Readout (DRO) on every Axis. Electronics are based on a AS5311 Linear Sensor. Magnetic Tape is SIKO 10mm, 10µm from [Paulimot](#).

Detailed Information:

[Zerspanungsbude-Forum](#)

[Bene-DRO](#)

Model files

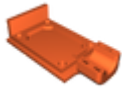

dro-lesekopf_cover.stl



dro-lesekopf-profil17mm.stl

Print files



dro-lesekopf_cover_02mm_petg_mk3s_27m.gcode

⚙ PET ⚙ 0.40 mm ⚙ 0.20 mm ⌚ 0.45 hrs ⚖ 4 g 🖨 Prusa MK3/S/S+



dro-lesekopf-profil17mm_02mm_greentec_mk3s_1h36.gcode

⚙ PLA ⚙ 0.40 mm ⚙ 0.20 mm ⌚ 1.59 hrs ⚖ 12 g 🖨 Prusa MK3/S/S+

License ©

This work is licensed under a
[Creative Commons \(4.0 International License\)](#)



Attribution—Noncommercial—Share Alike

- ✗ | Sharing without ATTRIBUTION
- ✓ | Remix Culture allowed
- ✗ | Commercial Use
- ✗ | Free Cultural Works
- ✗ | Meets Open Definition

