

Resin tank cleaning adaptor



Prusa Research

[VIEW IN BROWSER](#)

updated 24. 3. 2022 | published 24. 3. 2022

Summary

Helps you clean the SL1/SL1S SPEED FEP foil from cured resin leftovers.



0.55 hrs



1 pcs



0.05 mm



8 ml



Prusa SL1S
SPEED

[3D Printers](#) > [Accessories](#)

Tags: [adapter](#) [tank](#) [cleaning](#) [resin](#) [adaptor](#) [fep](#)
[surface](#)

This tiny part will help you get rid of cured resin leftovers stuck to the FEP foil on the bottom of the resin vat. Simply attach the part onto the front corner of the platform, trigger the cleaning procedure using the printer's touchscreen and let the printer do the rest automatically.

After the process is done, carefully remove all the leftovers stuck to the adaptor part.

The two distinct versions are for **SL1** and **SL1S SPEED** printers as the print platform shape differs slightly. Make sure your printer is running the firmware 1.7.0 beta or higher in order to be able to run the cleaning process automatically.

Printable on both SLA and FDM printers.

Model files

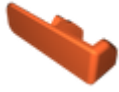

cleaning-adaptor-sl1.stl

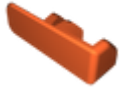

cleaning-adaptor-sl1s.stl

Print files



cleaning_adaptor_31m_50um_prusament_orange.sl1s

🕒 0.55 hrs 🌀 8 ml 📏 0.05 mm 💡 25s/2s 🖨️ Prusa SL1S SPEED

License ©

This work is licensed under a
GNU



General Public License v3.0

-
- ✗ | Sharing without ATTRIBUTION
 - ✓ | Remix Culture allowed
 - ✓ | Commercial Use
 - ✓ | Meets Open Definition
 - i | Share under the same license