

Mr. Bassan patented hinge tribute



SirJohn2024

VIEW IN BROWSER

updated 25. 4. 2019 | published 25. 4. 2019

Summary

This is a tribute to my father's patented hinge, he invented in the 60s (<https://patents.google.com/patent/US3209390>).

[Hobby & Makers](#) > [Mechanical Parts](#)

Tags: [hinge](#) [bassan](#)

This is a tribute to my father's patented hinge, he invented in the 60s (<https://patents.google.com/patent/US3209390>).

It's only a model showing the joint mechanics and cannot be used in an actual application due to the poor mechanical properties of FDM plastics, the real hinge is made of brass or steel (<https://youtu.be/oyA7kVHcAwM>). While its main feature is of being completely hidden when closed, in the 70s it has been used also in the iconic Micchel Prisma turntable transparent case (http://www.michell-engineering.co.uk/wp-content/uploads/michell_prisma_2.jpg).

Print instructions

The model is very big, you have to scale it down.
In order to assemble, you need to print the following:
2 bodies
6 levers

6 washers
4 screws
2 lateral pins
2 internal pins
1 middle pin (pivot)
See assembly pictures for reference.

Model files



body.stl



lever.stl



screw.stl



internal-pin.stl



lateral_pin.stl



middle_pin.stl

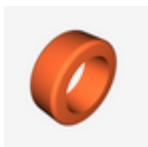

washer.stl

License ©

This work is licensed under a
Creative Commons (4.0 International License)



Attribution

- ✗ | Sharing without ATTRIBUTION
- ✓ | Remix Culture allowed
- ✓ | Commercial Use
- ✓ | Free Cultural Works
- ✓ | Meets Open Definition