

Stardew Valley Board Game Organizer (Sleeve Ready)



Gbutton

[VIEW IN BROWSER](#)

updated 12. 4. 2022 | published 22. 3. 2022

Summary

This is the first thing I've designed and printed. All walls are 1.6mm and the whole thing prints quite quickly with...

[Toys & Games](#) > [Outdoor Toys](#)

Tags: [organizer](#) [boardgames](#) [stardewvalley](#)

This is the first thing I've designed and printed. All walls are 1.6mm and the whole thing prints quite quickly with an 8mm nozzle.

I added two long boxes to help make it square, but they take the longest to print. They are meant to replace the crop and mine token holder that comes with the game. It's a little harder to see what you're getting, but you save a ton of table space.

I printed this on a prusa mini using an 8mm nozzle and got the whole thing done in about 12 hours.

Category: Toy & Game Accessories

Model files

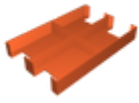

tools_and_bundles.stl

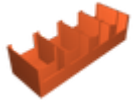

season_tokens.stl

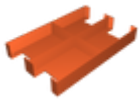

professions.stl

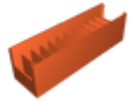

mine_and_animal_products.stl



quests_and_items.stl

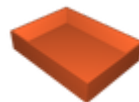

coin_box.stl



heart_box.stl



joja_tiles.stl

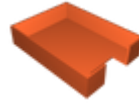

mine_levels.stl



buildings_and_animals.stl

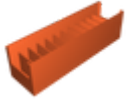

crops.stl

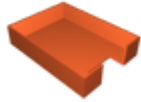

villagers.stl



mine_maps.stl



season_deck.stl

[Find source .stl files on Thingiverse.com](https://www.thingiverse.com)

License ©



This work is licensed under a
Creative Commons (4.0 International License)

Attribution—Noncommercial—Share Alike

- ✗ | Sharing without ATTRIBUTION
- ✓ | Remix Culture allowed
- ✗ | Commercial Use
- ✗ | Free Cultural Works
- ✗ | Meets Open Definition