

Dahua Video Doorbell VTO2202F-P Enclosure (VTM115)



hwmonkey

[VIEW IN BROWSER](#)

updated 12. 4. 2022 | published 22. 3. 2022

Summary

Two Surface mount designs for Dahua VTO2202F-P and VTO2202F-P-S2. The OEM part is VTM115. I designed this because...

[Household](#) > [Outdoor & Garden](#)

Tags: [case](#) [enclosure](#) [doorbell](#) [surfacemount](#) [dahua](#) [videodoorbell](#) [vtm115](#) [vto2202fp](#)

Two Surface mount designs for Dahua VTO2202F-P and VTO2202F-P-S2. The OEM part is VTM115. I designed this because Aliexpress delivered my doorbell but cancelled my order for the case, so it was designed based on the doorbell and not the specs of the original enclosure. I made the standard (non-angled) first, and when I saw the camera angle on my porch, I modified the design and created the second. Print this, buy two stainless bolts and washers to attach the doorbell, and grab 4 screws for mounting the box, and you are good to go.

I have the VTO2202F-P-S2 tied into Home Assistant directly (without an NVR) with push notifications to FireTVs and iPhones and an audible chime playing on the HASS Raspberry Pi, all running all in "local." It is a great

setup, although you may want to add a motion detector and always-on infrared light. Running the doorbell on POE with an ethernet cable (no wireless) works flawlessly.

Category: Outdoor & Garden

Model files



dahua_vto2202f-p_standard_case.stl

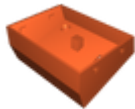

dahua_vto2202f-p_angled_case.stl

[Find source .stl files on Thingiverse.com](#)

License ©

This work is licensed under a
Creative Commons (4.0 International License)



Attribution

-
- ✗ | Sharing without ATTRIBUTION
 - ✓ | Remix Culture allowed
 - ✓ | Commercial Use
 - ✓ | Free Cultural Works
 - ✓ | Meets Open Definition