

Haptic Feedback Gear grind mod for SRT Gearbox

 **GWiz**

[VIEW IN BROWSER](#)

updated 12. 4. 2022 | published 23. 3. 2022

Summary

This is a mod of the SRT Gearbox to allow a little more free play in the gearbox in the locked position along with a...

[Hobby & Makers](#) > [Other Ideas](#)

Tags: [simracing](#)

This is a mod of the SRT Gearbox to allow a little more free play in the gearbox in the locked position along with a gear grind haptic feedback effect using a large rumble motor.

The mode of action is by integrating 4 magnets into a modified slider section that trigger a hall sensor on the plunger. By doing so, the 'clutch lock' can sense when the clutch is pressed and when the user is trying to shift gear without depressing the clutch but also preventing the activation of the grind effect when the gear lever is at rest.

It integrates a servo to allow activation of the clutch lock via switches.

Forgot to mention in the instructions - no need to add the little yellow spring into the new plunger, it's controlled by the servo and doesn't need the spring anymore.

Category: Hobby

Model files



mag_lock.stl



mount.stl



rumble_clamp_front.stl



rumble_clamp_mount.stl



plastic_magnet_spacer.stl

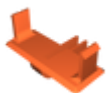

srt_arduino_cover_plate.stl



servo_arm.stl



plunger_insert.stl



gwiz_plunger.stl

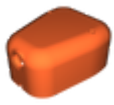

cover.stl



slider_section.stl

Other files



gwiz_gear_crunch.ino

[Find source .stl files on Thingiverse.com](#)

License

This work is licensed under a
Creative Commons (4.0 International License)



Attribution

-
- ✗ | Sharing without ATTRIBUTION
 - ✓ | Remix Culture allowed
 - ✓ | Commercial Use
 - ✓ | Free Cultural Works
 - ✓ | Meets Open Definition