

extruder arm robot flange



H.Zentani

[VIEW IN BROWSER](#)

updated 10. 3. 2023 | published 23. 3. 2022

Summary

Design and 3D printing of a flange to install a 3D printing head on an industrial robot arm.



1.92 hrs



1 pcs



0.30 mm



0.40 mm



PET



32 g



Prusa
MK3/S/S+

[3D Printers](#) > [3D Printers - Upgrades](#)

Tags: [robot](#) [arm](#) [e3d](#) [robotics](#) [e3dtitan](#) [e3dhotend](#)
[e3dv6](#) [mitsubishi](#) [e3dv6mount](#) [industrial](#) [5dof](#) [rv2aj](#)

Design and 3D printing of a flange to install a 3D printing head on an industrial robot arm.

Model files

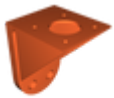

extruder-arm-robot-flange.stl









extruder-arm-robot-flange.3mf

Print files



extruder-arm-robot-flange_03mm_petg_mk3s_1h55m.gcode

 PET  0.40 mm  0.30 mm  1.92 hrs  32 g  Prusa MK3/S/S+

License



This work is licensed under a
Creative Commons (International License)

Public Domain

- ✓ | Sharing without ATTRIBUTION
- ✓ | Remix Culture allowed
- ✓ | Commercial Use
- ✓ | Free Cultural Works
- ✓ | Meets Open Definition