



## fiber clamp to optical table



Janoe

[VIEW IN BROWSER](#)

updated 24. 3. 2022 | published 24. 3. 2022

### Summary

Clamp to organize fibers on optical table. Fits M6 screw.



0.43 hrs



1 pcs



0.20 mm



0.40 mm



PLA



4 g



Prusa MINI /  
MINI+

[Learning](#) > [Physics & Astronomy](#)

Tags: [laser](#) [lab](#) [laboratory](#) [fiber](#) [laboratoryclamp](#)  
[laserlab](#)

Printed in PLA 0.2mm upside down with supports for countersunk screw hole.

Fits typical M6 (DIN 912 / ISO 4762) screws with cylindrical hexagon socket head cap screw.

## Model files

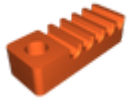

**fiber\_clamp.3mf**

## Print files



**fiber\_clamp\_02mm\_pla\_mini\_26m.gcode**

🌀 PLA 🌀 0.40 mm ≡ 0.20 mm ⌚ 0.43 hrs ⚖️ 4 g 🖨️ Prusa MINI / MINI+

## License ©



This work is licensed under a  
[Creative Commons \(4.0 International License\)](https://creativecommons.org/licenses/by-nc/4.0/)

**Attribution-NonCommercial**

- 
- ✖ | Sharing without ATTRIBUTION
  - ✓ | Remix Culture allowed
  - ✖ | Commercial Use
  - ✖ | Free Cultural Works
  - ✖ | Meets Open Definition