



RC Fanmount 40mm

 **Florian Kogler**

[VIEW IN BROWSER](#)

updated 24. 3. 2022 | published 24. 3. 2022

Summary

This is a Motor Fanmount for a RC-Car. It is made for an 40mm Fan. I don't recommend to use PLA!

[Hobby & Makers](#) > [RC & Robotics](#)

Tags: [rc](#) [motor](#) [mount](#) [fan](#) [fanmout](#)

PETG is recommended.

You need to enable supports on build plate only!

I have added a version with a brim, if you have problems with printing.

The fan is mounted with four M3 screws. Be sure about the right length. Too long scewes will damage the print.

Model files

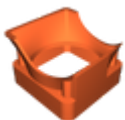

kf-3d-lufter-40mm.stl



kf-3d-lufter-40mm-brim.stl

License ©

This work is licensed under a
[Creative Commons \(4.0 International License\)](#)



Attribution-NonCommercial

- ✗ | Sharing without ATTRIBUTION
- ✓ | Remix Culture allowed
- ✗ | Commercial Use
- ✗ | Free Cultural Works
- ✗ | Meets Open Definition