



FLSUN spool holder

 **Matěj**

[VIEW IN BROWSER](#)

updated 21. 4. 2023 | published 21. 4. 2023

Summary

Simple enhanced version of FLSUN stock spool holder, now added a bigger V400 version

[3D Printers](#) > [3D Printers - Upgrades](#)

Tags: [thingiverse](#) [flsun](#) [flsundelta](#)

UPDATE: i am adding a longer version for wider spools, as i just bought 3djake brand spool and its too wide for the original spool holder, so if anyone is using wider spools, use the long version. (cura will throw a message to fix the model but it prints fine)

UPDATE no.2 added V400 version

Simple enhanced version of FLSUN stock spool holder (made for the SR but from what i've seen flsun uses the same spool holder on other printers). Just print and then press fit into the stock spool holder(it takes some force to put it in). You will need two 608 bearings (i think its 608,pulled mine out of old fidget spinner). The cone is so you can put any spool on it (like the prusa ones, that are hollow inside).

You need to use supports for the spool holder itself, but i found them really easy to remove without any residue left behind(should be the same for anybody if using my settings).

Final version looks slightly different from the photos, but functionality stays the same.

Shoutout to [@dvdphil_133328](#) for help with the V400 version

Any feedback appreciated.

Print Settings

Printer:

FLSUN SR

Rafts:

No

Supports:

Yes

Resolution:

0.2

Infill:

20%

Filament:

Prusament PLA

silver

Notes:

support pattern: Lines

support density: 25%

fill gaps between walls: Everywhere

How I Designed This

Side note

i desined it in Blender by editing old stl for ender 3 spool holder that i can no longer find on thingiverse, because i used blender and not CAD it became an accidental press-fit and i am planning to make another version that is just put in place without using force(but this seems to be perfect for me).

Category: 3D Printer Parts

This remix is based on



FLSUN spool holder

by MrNovus

Model files

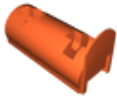

spool_holder_v1.stl



bearing_insert.stl



cone.stl

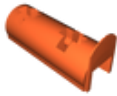

spool_holder_v1_long.stl

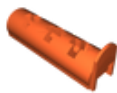

v400_spool_holder.stl

[Find source .stl files on Thingiverse.com](#)

License

This work is licensed under a
Creative Commons (4.0 International License)



Attribution-NonCommercial

- ✗ | Sharing without ATTRIBUTION
- ✓ | Remix Culture allowed
- ✗ | Commercial Use
- ✗ | Free Cultural Works
- ✗ | Meets Open Definition