



Apple logo glowing wled or led



Satellietje

[VIEW IN BROWSER](#)

updated 24. 3. 2022 | published 24. 3. 2022

Summary

Apple logo glowing wled or led

[Household](#) > [Home Decor](#)

Tags: [decoration](#) [3d](#) [logo](#) [light](#) [led](#) [gift](#) [apple](#) [wled](#)

Fits in the project Glowing LED and WLED all alphabet letters and all numbers 10 cm high.
<https://www.prusaprinters.org/prints/149829-glowing-led-and-wled-all-alphabet-letters-and-all->

You are doing me a big favor by clicking the Like button :-)

Shopping list for use with WS2812B leds
WS2812B RGB Led (AliExpress)
Wemos D1 Mini V3.0.0 (AliExpress)
Wire thin 28AWG (AliExpress)
Black Filament - Sunlu Black
Warm white Filament - E-Sun white-B (Not Snowwhite)
Solder tin
Glue
5 Volt usb micro adapter

Print Apple logo in black or other non-translucent color.
Diffuser warm white or white, for example, Esun white-b.
Print only the parts that you need.

Put some glue on de edge of the lens, and place the lens in the letter press firmly.

If there is a mistake let me know and I fix it.
For questions send me a message. I would like to help you make this beautiful project ;-)

Programming the Wemos
its very simple, look here:
<https://kno.wled.ge/basics/install-binary/>
Metthod 3: ESP Home Flasher tool

Link to the flasher:
<https://github.com/esphome/esphome-flasher/releases>

Link to the bin file:
<https://github.com/Aircoookie/WLED/releases>

Open the ESPHome-Flasher-1.4.0-Windows-x64.exe

1. Choose the comport that your WEMOS is on
2. Browse in the flasher to WLED_****.bin
3. Click on Flash Esp

Thats it

If you don't want to use the WS2812B, you can also use a normal diffused 5 mm LEDs.
An adapter is included for this.

In my previous project there are pictures about the LEDs and the connections:
<https://www.prusaprinters.org/prints/109865-glowing-wled-or-led-all-alphabet-letters-and-all-n>

Model files

apple-logo-diffuser.stl





apple-logo-back.stl



apple-logo.stl



adapter.stl



coupler.stl



closing-cap.stl

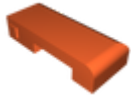

side-right.stl

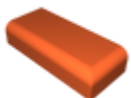

side-left.stl

License

This work is licensed under a
[Creative Commons \(4.0 International License\)](https://creativecommons.org/licenses/by-nc-nd/4.0/)



Attribution—Noncommercial—No Derivatives

- ✖ | Sharing without ATTRIBUTION
- ✖ | Remix Culture allowed
- ✖ | Commercial Use
- ✖ | Free Cultural Works
- ✖ | Meets Open Definition