



# Xiaomi Mi Watch Magnetic USB-C Charger



NightHawk

[VIEW IN BROWSER](#)

updated 30. 3. 2022 | published 30. 3. 2022

## Summary

Small and portable magnetic USB-C charging adapter to charge your Xiaomi Mi Watch.

[Gadgets](#) > [Portable Devices](#)

Tags: [charger](#) [dock](#) [adapter](#) [watch](#) [usb](#) [xiaomi](#) [usbc](#)  
[fitness](#) [mi](#)

## Required hardware:

- 8x 1.7x4 self tapping counter sunk screws
- 1x [Adafruit USB-C breakout](#)
- 2x [Pogo Pins 2mm](#)
- 2x cube magnet 5x5x5mm
- some silicon cable

## Assembly Instructions:

- Put the magnets on the back of your watch to make sure you got them oriented the right way. You may use some heat to push them fully into the part.

- The pogo pins need so be placed approximately above the holes and are then melted into the part by using a soldering iron. Be careful to not apply too much pressure or to melt the entire part :-).

## Available Files :

- mi\_watch\_charger\_bottom: base part to mount all the hardware
- mi\_watch\_charger\_top: cover to hide all the mess inside

## Printing Instructions

- Prusament PETG Urban Grey
- layer height 0.15mm
- No support
- No raft

## Feedback Appreciated

Please give feedback and post your makes. Any suggestions and improvements are appreciated.

## Model files



mi\_watch\_charger\_top\_v7.stl

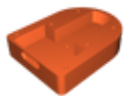

mi\_watch\_charger\_bottom\_v7.stl

## License ©

This work is licensed under a  
[Creative Commons \(4.0 International License\)](#)



**Attribution-NonCommercial**

- ✗ | Sharing without ATTRIBUTION
- ✓ | Remix Culture allowed
- ✗ | Commercial Use
- ✗ | Free Cultural Works
- ✗ | Meets Open Definition