



# Nintendo Switch Dock Alternate V1



kwigbo

[VIEW IN BROWSER](#)

updated 22. 12. 2022 | published 22. 12. 2022

## Summary

This is an alternate Nintendo Switch Dock.

[Gadgets](#) > [Video Games](#)

Tags: [mario](#) [nintendo](#) [switch](#) [zelda](#) [joycon](#)  
[nintendoswitch](#) [electronics](#) [wii](#) [wiiu](#)

**WARNING:** I am not responsible if you destroy your dock. For this print to be useful the original dock has to be dismantled. This will most likely void any warranty you may have on it. Please be sure you know what you are doing before attempting this project.

**UPDATE 1:** Added ventilation slots to the back.

**UPDATE 2:** Added SwitchHubTubeFlex.stl so you can print without the space taken for the felt.

This is my design for an alternate Nintendo Switch dock. It uses all the parts from the original dock. I was very disappointed with the one provided by Nintendo.

**Note:** I still have to figure a good way to integrate the LED light.

**Instructions:** Print all parts and assemble. Just need 8 machine screws and all the parts from the original Switch dock.

4 - 12mm (Length) x 2.75mm (Thread Diameter)  
2 - 12mm (Length) x 2.1mm (Thread Diameter)  
2 - 6mm (Length) x 2.1mm (Thread Diameter)  
Piece of 1mm thick felt

## Print instructions Category: Video Games Print Settings

**Printer Brand:** MakerGear

**Printer:** MakerGear M2

**Supports:** No

**Resolution:** 0.2

## This remix is based on



**Nintendo Switch Alternate Dock**

by kwigbo

## Model files



**lid.stl**



**casebottom.stl**



**switchhubtube.stl**



**switchhubcase.skp**



**casetop.stl**

---

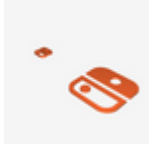

**switchlogo.stl**

---



**switchhubtubeflex.stl**

---

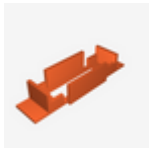

**clip.stl**

---

[Find source .stl files on Thingiverse.com](#)

## License ©



This work is licensed under a  
**Creative Commons (4.0 International License)**

**Attribution—Noncommercial—Share Alike**

---

- ✗ | Sharing without ATTRIBUTION
- ✓ | Remix Culture allowed
- ✗ | Commercial Use
- ✗ | Free Cultural Works
- ✗ | Meets Open Definition