

Art Decco 5 Piece Puzzle



Lockwatcher

[VIEW IN BROWSER](#)

updated 6. 2. 2023 | published 6. 2. 2023

Summary

I saw a puzzle like this a very long time ago, and have recreated it here (but with a unique look). Easy to print!



6.19 hrs



2 pcs



0.15 mm



0.40 mm



PLA



70 g



Prusa
MK3/S/S+

[Toys & Games](#) > [Puzzles & Brain-teasers](#)

Tags: [puzzlepieces](#) [puzzles](#)

I saw a puzzle like this a very long time ago, and have recreated it here (but with a unique look). Easy to print!

The pieces are very loose within the frame. you need to position the piece's so that they interlock, and the puzzle can be moved about, with no loose parts!

This puzzle has six parts, the piece's (5) and the frame (1).

Print the frame:

I printed the frame with Inland Black Pla/PLA+ and Inland Silk Silver. The included print file has a built in pause for changing the filament for the trim around the frame.

Printing the pieces:

I printed the pieces with Inland Silk Silver, the included print file includes all five parts needed. I have also included separate stl files as well if you wish to slice your own.

Please enjoy

See my other prints on Prusa Printers!

Model files



puzzle-frame.stl

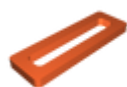

3-piece-1.stl



2-piece-2.stl



all-pieces.stl

Print files



puzzle-pieces_015mm_pla_mk3s_1h41m.gcode

PLA 0.40 mm 0.15 mm 1.68 hrs 14 g Prusa MK3/S/S+



puzzle-frame_015mm_pla_mk3s_4h31m.gcode

PLA 0.40 mm 0.15 mm 4.51 hrs 56 g Prusa MK3/S/S+

License

This work is licensed under a
[Creative Commons \(4.0 International License\)](#)



Attribution—Noncommercial—Share Alike

-
- ✗ | Sharing without ATTRIBUTION
 - ✓ | Remix Culture allowed
 - ✗ | Commercial Use
 - ✗ | Free Cultural Works
 - ✗ | Meets Open Definition