

## Stern Pinball Machine Spike 2 Fan Adapter (40mm to 60mm)

 plasticbugs

[VIEW IN BROWSER](#)

updated 8. 5. 2023 | published 8. 5. 2023

### Summary

This adapter connects a supplemental fan to your Stern Pinball machine power supply fan to replace the loud internal one



1.60 hrs



1 pcs



0.20 mm



0.40 mm



PLA



16 g



Prusa MINI /  
MINI+

[Gadgets](#) > [Other Gadgets](#)

Tags: [adapter](#) [fan](#) [pinball](#) [stern](#)

This is an adapter which allows you to connect a supplemental fan to your Stern Pinball machine power supply fan to prevent the smaller, much noisier fan from spinning up. The larger fan mounted above should prevent the smaller fan from kicking on. This adapter saves you from opening the covered power supply and replacing the VERY NOISY smaller fan (and thus voiding your warranty).

This adapter should also fit a Mean Well RSP-500-24 (see user comments).

DID I MENTION HOW LOUD THAT SMALL FAN IS?

Print with larger fan opening flat on the print bed. Requires supports for the single screw hole on the 40mm side.

This adapter is for mounting a secondary (larger and quieter) fan on top of the very noisy pre-existing power supply fan inside of modern Stern pinball machines. The fan I'm using is a Noctua NF-A6x25, which runs on 12 Volts and can be connected to the power supply circuit board directly below and to the left of the power supply enclosure.

This adapter attaches to the power supply via the existing front screw, the rear screw can be left in place. Then, the Noctua fan attaches to the adapter using the rubber posts that come with the fan.

I'm using the three-pin connector from Pinball Life: <https://www.pinballlife.com/spike-12-volt-backbox-power-adapter-cable.html> -- and have connected the ground and power wires to the fan's ground and power wires. Red to red. Black to black. The yellow wire on the fan does not get connected to anything.

## Model files

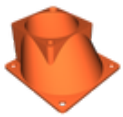

**40mm\_fan\_adapter\_stern\_v2.stl**

## Print files



**40mm\_fan\_adapter\_stern\_v2\_02mm\_pla\_mini\_1h36m.gcode**

PLA 0.40 mm 0.20 mm 1.60 hrs 16 g Prusa MINI / MINI+

## License ©

This work is licensed under a  
**GNU**



- ✗ | Sharing without ATTRIBUTION
- ✓ | Remix Culture allowed
- ✓ | Commercial Use
- ✓ | Meets Open Definition
- i | Share under the same license