



## Zesty Nimble V1 Breech



bjoern85

[VIEW IN BROWSER](#)

updated 27. 12. 2019 | published 27. 12. 2019

### Summary

This is a breech for your zesty nimble V1. It makes it possible to set up the tension to the extruder gear.

[3D Printers](#) > [3D Printers - Upgrades](#)

Tags: [sparepart](#) [thezestynimble](#) [zesty](#) [zestytechnology](#)  
[breech](#)

This is a breech for your zesty nimble V1.

It makes it possible to set up the tension to the extruder gear.

I've printed the things in Prusament PETG with a Ø0.25 Nozzle.

Feedback is welcome.

### Print instructions

Use a small Nozzle and low layer height.

No support should be needed.

## Model files

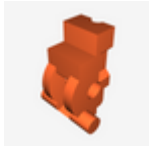

**breech.stl**



**clip.stl**



**nut.stl**

## License

This work is licensed under a  
[Creative Commons \(4.0 International License\)](https://creativecommons.org/licenses/by-nc-sa/4.0/)



**Attribution—Noncommercial—Share Alike**

- 
- ✗ | Sharing without ATTRIBUTION
  - ✓ | Remix Culture allowed
  - ✗ | Commercial Use
  - ✗ | Free Cultural Works
  - ✗ | Meets Open Definition