



Soldering station - solder and flux holder

D DT

[VIEW IN BROWSER](#)

updated 30. 3. 2022 | published 30. 3. 2022

Summary

Yet another solder dispenser - but this time a flux holder integrated as well

[Hobby & Makers](#) > [Electronics](#)

Tags: [soldering](#) [solder](#) [solderingstation](#) [flux](#)

This was a quick and simple design to get the solder and flux off my bench and make it easy for me to move them around.

The spindle for the solder slots into the holder which should make it simple to change solder while still keeping it in place.

Model files



[solderholder.stl](#)

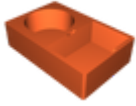

solderstation.stl



spoolspindle.stl

License

This work is licensed under a
[Creative Commons \(4.0 International License\)](https://creativecommons.org/licenses/by/4.0/)



Attribution

- ✘ | Sharing without ATTRIBUTION
- ✓ | Remix Culture allowed
- ✓ | Commercial Use
- ✓ | Free Cultural Works
- ✓ | Meets Open Definition