



Pi 4 Snapfit 60mm fan case



Ash

[VIEW IN BROWSER](#)

updated 20. 8. 2024 | published 20. 8. 2024

Summary

This is my original design inspired by John Sinclair's idea of showing the infill of the print...

[Hobby & Makers](#) > [Electronics](#)

Tags: [fan](#) [raspberry](#) [snapfit](#) [cooling](#) [raspberrypi](#)
[raspberrypicase](#) [screwless](#) [thingiverse](#) [coolingfan](#)
[raspberrypi4b](#) [raspberrypi4bcase](#) [quickfit](#) [glueless](#)

Note: This is an old model that I am keeping up as people are still downloading it, apologies for the terrible cover photo.

This is a later version of my 60mm fan snapfit case design and features a screwless design that allows the Pi and fan to clip into place. The whole case also snaps together nicely and comes apart by squeezing it along the longest sides.

To get the cool mesh make sure you print with 0 top or bottom layers and use a 2D infill pattern, I used the triangle infill pattern at 30-60% infill with infill line directions at 90°.

Print Settings

Supports:

No

Resolution:

0.2

Infill:

30-60%

Notes:

PLEASE MAKE SURE TO USE 0 TOP AND BOTTOM LAYERS TO ACHIEVE THE MESH.

Model files



pi_4_case_bottom_logo.stl

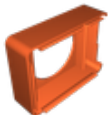

pi_4_case_top.stl



pi_4_case_bottom.stl

[Find source .stl files on Thingiverse.com](#)

License ©

This work is licensed under a
[Creative Commons \(International License\)](#)



Public Domain

- ✓ | Sharing without ATTRIBUTION
- ✓ | Remix Culture allowed
- ✓ | Commercial Use
- ✓ | Free Cultural Works
- ✓ | Meets Open Definition