

3D MODEL ONLY

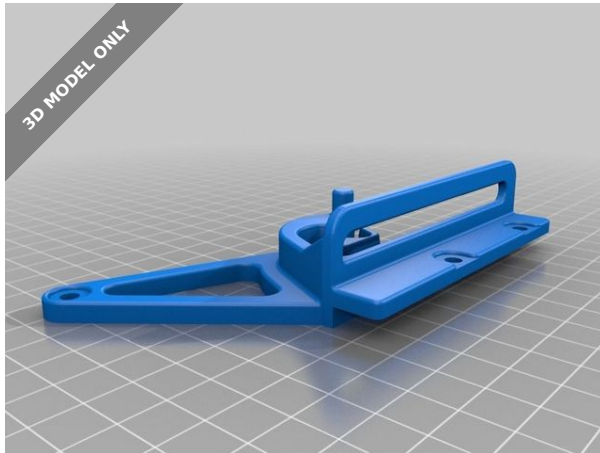

Mechanism to stop locker door closing

**Tim Angus**[VIEW IN BROWSER](#)

updated 23. 7. 2024 | published 23. 7. 2024

Summary

https://youtu.be/OZVSO_NX0vo My locker at work has spring loaded hinges which makes it incredibly annoying to use if...

[Household](#) > [Other House Equipment](#)

Tags: [mechanism](#) [locker](#) [thingiverse](#) [annoying](#)

My locker at work has spring loaded hinges which makes it incredibly annoying to use if you've got your hands full, which you inevitably do when you've just got changed. So I fixed it.

Category: Replacement Parts

This remix is based on

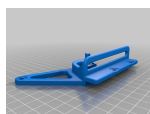
**Mechanism to stop locker door closing**

by timangus

Model files



bar-holder-back.stl



locker-stopper.stl



bar-holder-front.stl

[Find source .stl files on Thingiverse.com](https://www.thingiverse.com)

License ©



This work is licensed under a
Creative Commons (4.0 International License)

Attribution—Noncommercial—Share Alike

- ✗ | Sharing without ATTRIBUTION
- ✓ | Remix Culture allowed
- ✗ | Commercial Use
- ✗ | Free Cultural Works
- ✗ | Meets Open Definition