

SZHD/RZHD railcar bogie 1:87 (H0)

[VIEW IN BROWSER](#)

updated 28. 12. 2019 | published 28. 12. 2019

Summary

Railcar bogie, model 18-100. Used for most soviet/russian railcars from 1960s till now.

[Toys & Games](#) > [Vehicles](#)

Tags: [railway](#) [train](#) [railcar](#) [bogie](#)

Railcar bogie, model 18-100. Used for most soviet/russian railcars from 1960s till now.

Print instructions

Three variants of crossbar included: without mounting hole, with one, and full variant with hole and sliders. Real bogie always have sliders, but it is hard to print while you often even don't see sliders after wagon mounting. So I made simplified variants.

Two variants of wheel: old with holes (was used till the end of XX century), new without ones (used now).

If printing seems too complex, use simplified parts (with first letter "S" in their names). You can combine them with original parts in couple of variants to print bogie more easily.

Model files



18-100-h0-rbx-sd1.stl



18-100-h0-rbx-sd2.stl



18-100-h0-rbx-bl.stl



18-100-h0-rbx-bl-os.stl



18-100-h0-rbx-bl-otv.stl



wheel950-h0.stl

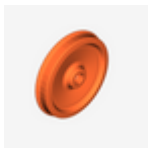

wheel950-2k-h0.stl



s18-100-h0-rbx-bl.stl



s18-100-h0-rbx-in.stl



s18-100-h0-rbx-sdpr.stl



s18-100-h0-rbx-sd.stl

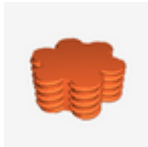

s18-100-h0-rbx-pr.stl



s18-100-h0-rbx-blpr.stl

License

This work is licensed under a
[Creative Commons \(4.0 International License\)](https://creativecommons.org/licenses/by-sa/4.0/)



Attribution-ShareAlike

- ✗ | Sharing without ATTRIBUTION
- ✓ | Remix Culture allowed
- ✓ | Commercial Use
- ✓ | Free Cultural Works
- ✓ | Meets Open Definition