

## Snowboard Forward Lean Block



loidolt

[VIEW IN BROWSER](#)

updated 12. 4. 2022 | published 30. 3. 2022

### Summary

Replacement forward lean block for a snowboard binding to replace a worn out and damaged part. Based on the worn out...

[Sports & Outdoor](#) > [Other Sports](#)

Tags: [snowboard](#) [snowboarding](#) [bindings](#)

Replacement forward lean block for a snowboard binding to replace a worn out and damaged part. Based on the worn out part taken off a pair of Union Bindings.

### Instructions

Print standing up on the flat end at 100% or 70% fill. The teeth will print great without any support this way. Due to the small footprint, print with a large brim.

Recommend abs for strength as this is a mechanical part that will have considerable forces imparted on it on hard heel-side turns, landings, etc. Pla seems to work fine as well, just probably wont last quite as long.

Category: Sport & Outdoors

# Model files

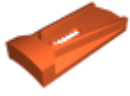

snowboard\_binding\_forward\_lean\_block.stl



snowboard\_binding\_forward\_lean\_block.skp

[Find source .stl files on Thingiverse.com](#)

## License ©

This work is licensed under a  
**Creative Commons (4.0 International License)**



**Attribution-ShareAlike**

- 
- ✗ | Sharing without ATTRIBUTION
  - ✓ | Remix Culture allowed
  - ✓ | Commercial Use
  - ✓ | Free Cultural Works
  - ✓ | Meets Open Definition