

# Linear Double Screw Rail (1010)



Core3D.tech

[VIEW IN BROWSER](#)

updated 12. 4. 2022 | published 30. 3. 2022

## Summary

For more information on how to assemble and what parts to get check out <https://www.instructables.com/id/Linear-Screw-...>

[3D Printers](#) > [3D Printers - Upgrades](#)

Tags: [80201010](#) [1010](#) [linearrail](#)

For more information on how to assemble and what parts to get check out <https://www.instructables.com/id/Linear-Screw-Double-Rail/>

If you like what you see and wish to download, please consider pushing the Tip Designer Button. If you want to see more coming your way, consider supporting me though [https://www.patreon.com/Core3d\\_tech](https://www.patreon.com/Core3d_tech)

Category: 3D Printer Parts

## Model files

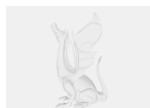

slider.stl



**endconnector.stl**

---



**nemaconnector.stl**

---

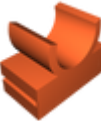

**endstopcase12mm.stl**

---



**nemaconnector12mm.stl**

---



**endstopcase.stl**

---



**slider12mm.stl**

---



**endconnector12mm.stl**

[Find source .stl files on Thingiverse.com](https://www.thingiverse.com)

## License ©

This work is licensed under a  
[Creative Commons \(4.0 International License\)](https://creativecommons.org/licenses/by/4.0/)



**Attribution**

---

- ✘ | Sharing without ATTRIBUTION
- ✓ | Remix Culture allowed
- ✓ | Commercial Use
- ✓ | Free Cultural Works
- ✓ | Meets Open Definition