

Prusa mini sensor box with bigger gap



RaptorSLegacyY

[VIEW IN BROWSER](#)

updated 30. 3. 2022 | published 30. 3. 2022

Summary

I wanted a sensor box, but with a bigger gap, i felt that the gap was to fiddly so this one is deeper

[3D Printers](#) > [3D Printers - Upgrades](#)

Tags: [prusa](#) [box](#) [mini](#) [sensor](#) [prusamini](#)

I wanted a box with a deeper seam so the cables are easy to manage i also added a bigger front so you can add some PTFE, so the filament will not rub against the PETG but goes smooth inside, hope you guys like it

This remix is based on

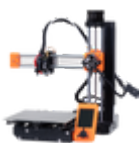

MINI+ Printable parts

by Prusa Research

Model files

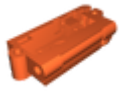

mini-sensor-box.stl

License ©

This work is licensed under a
[Creative Commons \(International License\)](#)



Public Domain

-
- ✓ | Sharing without ATTRIBUTION
 - ✓ | Remix Culture allowed
 - ✓ | Commercial Use
 - ✓ | Free Cultural Works
 - ✓ | Meets Open Definition