



## door stopper for cats (defined gap)

B Buzz

[VIEW IN BROWSER](#)

updated 8. 8. 2022 | published 8. 8. 2022

### Summary

When our cat enters the room, she opens the door very wide. Which is not wanted to keep the bedroom dark and cool. So...

[Household](#) > [Other House Equipment](#)

Tags: [bedroom](#) [cat](#) [door](#) [doorstopper](#) [magnet](#)

When our cat enters the room, she opens the door very wide. Which is not wanted to keep the bedroom dark and cool.

So I added a small piece with some 6mm magnets to the door (just clip on with some foam tape) and a magnetic counterpart on a arm to the wall.

This generates a soft stop of the door at a small gap, wide enough for our cat to enter. The door can still open and close fully.

Looks silly, but it works :)

Fits all on a 200mm printer bed and prints without support. (Orientate the tip in the holes upwards)

Screw all together with M4x30 screws and some nuts, insert 6mm diameter magnets (max. 4mm high) - done

Have a good long sleep in on weekends on me!

Cheers,

Sebastian

Category: Household

## Model files



**middleconnector.stl**

---



**magnetholder.stl**

---

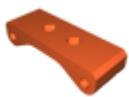

**wallmount.stl**

---



**arm.stl**

---



**doorclip.stl**

[Find source .stl files on Thingiverse.com](https://www.thingiverse.com/thing/1111111)

## License ©

This work is licensed under a  
**Creative Commons (4.0 International License)**



**Attribution**

---

- ✖ | Sharing without ATTRIBUTION
- ✔ | Remix Culture allowed
- ✔ | Commercial Use
- ✔ | Free Cultural Works
- ✔ | Meets Open Definition