

Key holder



tolape

[VIEW IN BROWSER](#)

updated 3. 1. 2024 | published 3. 1. 2024

Summary

Allows you to carry the keys comfortably when you go running.

[Sports & Outdoor](#) > [Outdoor Sports](#)

Tags: [keyholder](#)

Allows you to carry the keys comfortably when you go running.

Required material: printed parts x3, x2 DIN7985 M3x12 screws and x2 DIN985 M3 nuts.

Using PLA as a printing material, the strength of the product is enough to fulfill its function.

Model files



base-inferior.stl



tapa-superior.stl

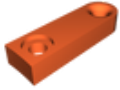

complement-anella.stl

License ©

This work is licensed under a
[Creative Commons \(4.0 International License\)](#)



Attribution-NonCommercial

- ✗ | Sharing without ATTRIBUTION
- ✓ | Remix Culture allowed
- ✗ | Commercial Use
- ✗ | Free Cultural Works
- ✗ | Meets Open Definition