

## Ender 3/CR10 - Tool mount



ToXlcDev

[VIEW IN BROWSER](#)

updated 8. 8. 2022 | published 8. 8. 2022

### Summary

Can be used to mount a pen, soldering iron (for wood burning), wood burning pen or whatever else you can think off. I...

[3D Printers](#) > [3D Printers - Upgrades](#)

Tags: [cr10](#) [creality](#) [crealitycr10](#) [ender](#) [mount](#) [pen](#)  
[tool](#)

Can be used to mount a pen, soldering iron (for wood burning), wood burning pen or whatever else you can think off.

I know there are other probably stronger ways (although this way is pretty strong) of doing it but I wanted a way that meant you didn't need to take off the hotend.

The cutout is about 18mm wide.

Use [this](#) guide to learn how to create the gcode but remember to set your Z offset (if needed) in the path to gcode part.

### Print Settings

**Supports:**

No

**Resolution:**

0.2

**Infill:**

50%

**Post-Printing**

You'll need some M3 bolts and nuts for the clamp.

You might need to drill out the M3 holes as they were a bit tight for me (still usable but annoying)

I did manage to crack the part that connects to the fan bolts (when using the original version) but that might have just been me tightening it too much, I have created a thicker version (which I would recommend you use) that should be stronger but you would need to replace the original fan mount bolts with longer ones (they are M2, I used 12mm long ones)

Category: 3D Printer Parts

## Model files

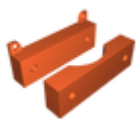

**tool\_mount.stl**



**tool\_mount\_-\_thick.stl**

[Find source .stl files on Thingiverse.com](#)

## License ©

This work is licensed under a  
[Creative Commons \(4.0 International License\)](#)



## Attribution

---

- ✗ | Sharing without ATTRIBUTION
- ✓ | Remix Culture allowed
- ✓ | Commercial Use
- ✓ | Free Cultural Works
- ✓ | Meets Open Definition